



Colosseo Block *New*



- Two choices of sizing, both with an architectural block look and finished corners on all units
- Smooth texture on both faces—can be installed on either side
- Cored block, which provides increased adhesion to mortar and eases the installation (lighter units)
- Ideal for institutional, commercial, industrial projects that require fast and economical installation

	A	B
Weight per cube (kg)	1 404	990
Rows per cube	5	4
Sq.ft. per row	19.14	19.31
Sq.ft. per cube	95.72	77.24
Corner pieces	100%	100%
Lin. ft. per row	30.71	30.97
Lin. ft. per cube	153.54	123.88
Qty per cube	120 units	64 units

A	90 x 190 x 390 mm	4 x 8 x 16 in.
B	90 x 190 x 590 mm	4 x 8 x 24 in.

Code 8 x 16	Code 8 x 24	Colour
169001786	169001789	Charcoal
169001787	169001790	Optra
169001788	169001791	Sterling

Units A and B are sold separately

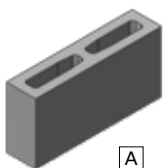

A

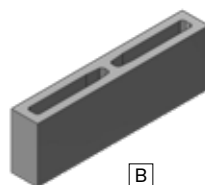

B

Laying Patterns:

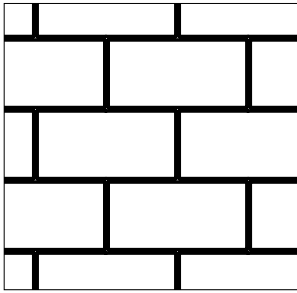

Running Bond - 8 in. x 16 in.

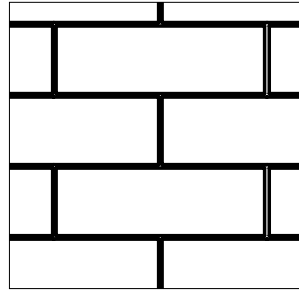

Running Bond - 8 in. x 24 in.

Typical Rows:

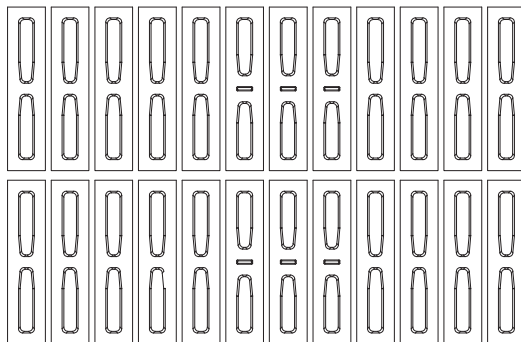

8 x 16

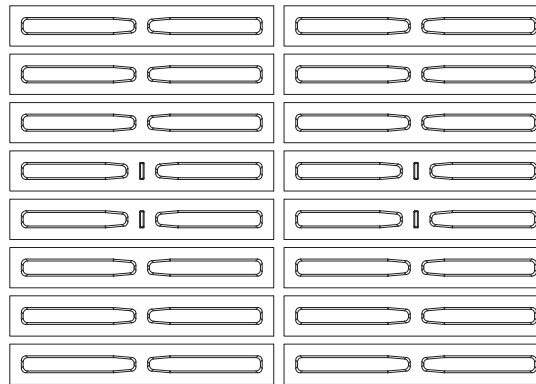

8 x 24

Technical information

Product	Standard	Compressive Strength	Density	Absorption	Dimension Tolerance	Fire Resistance (CNB)
Colosseo Block 8 x 16	CSA A165.1	15 MPa	A : Over 2000 kg/m ³	A : 175 kg/m ³	Thickness: ±2.0 mm Height: ±2.0 mm Length: ±3.0 mm	0.80 hours
Colosseo Block 8 x 24	CSA A165.1	15 MPa	A : Over 2000 kg/m ³	A : 175 kg/m ³	Thickness: ±2.0 mm Height: ±2.0 mm Length: ±3.0 mm	0.80 hours